

CPS in Hall C

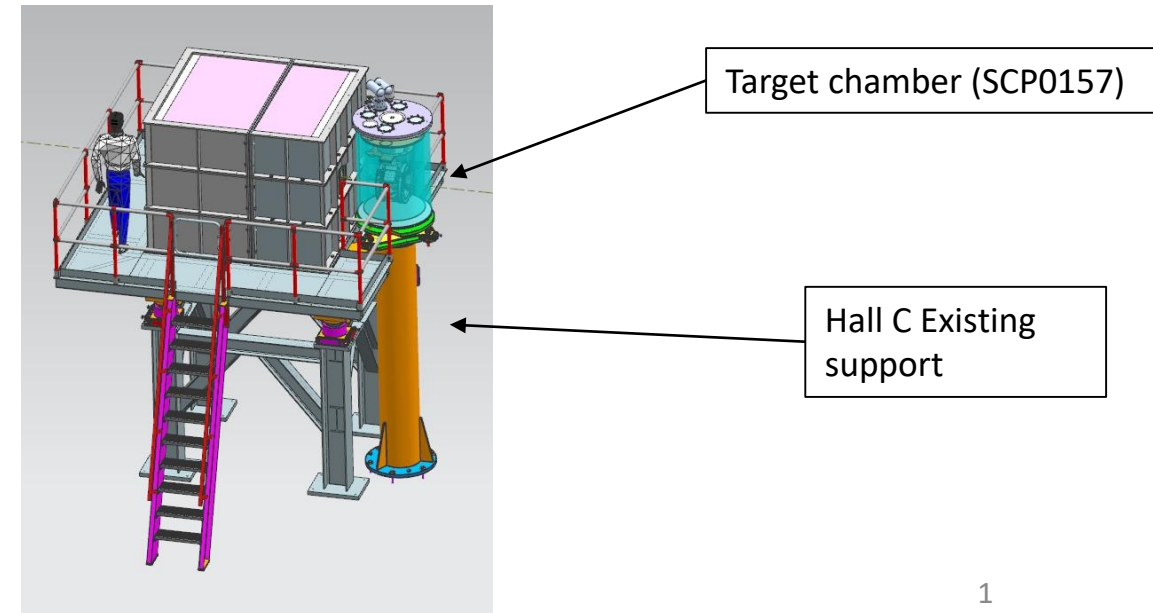

Getting Big Bite Magnet over SHMS

Big Bite Magnet can be disassembled and lifted over the SHMS with Hall C standard crane

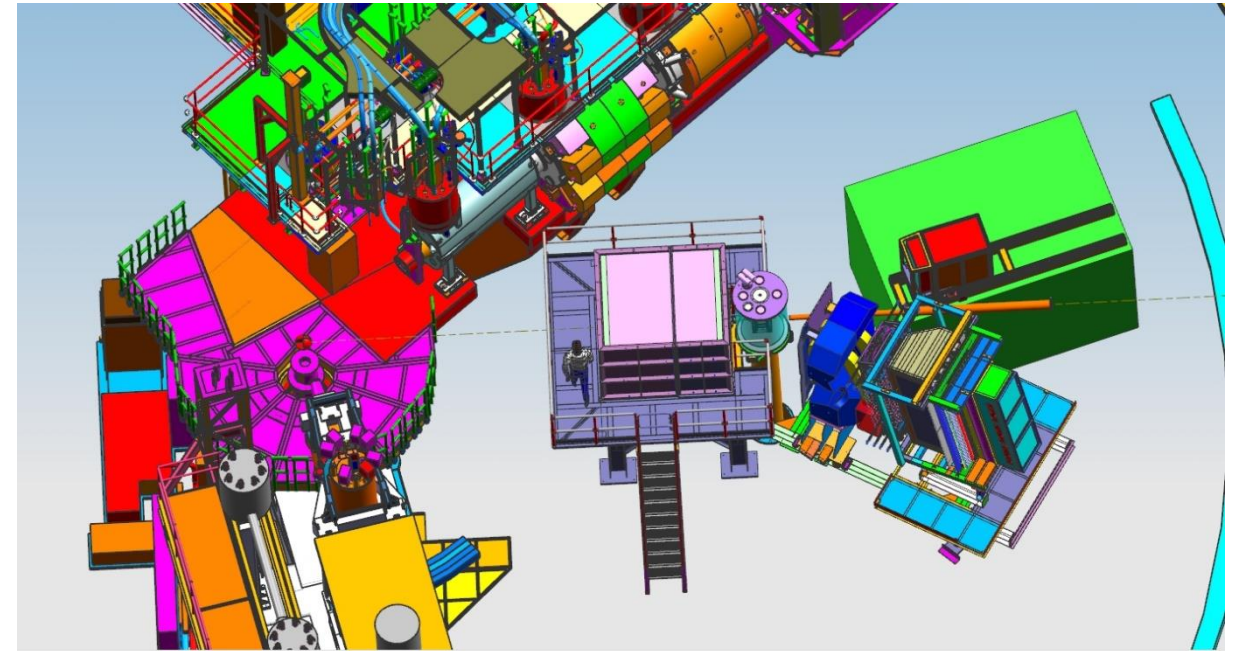
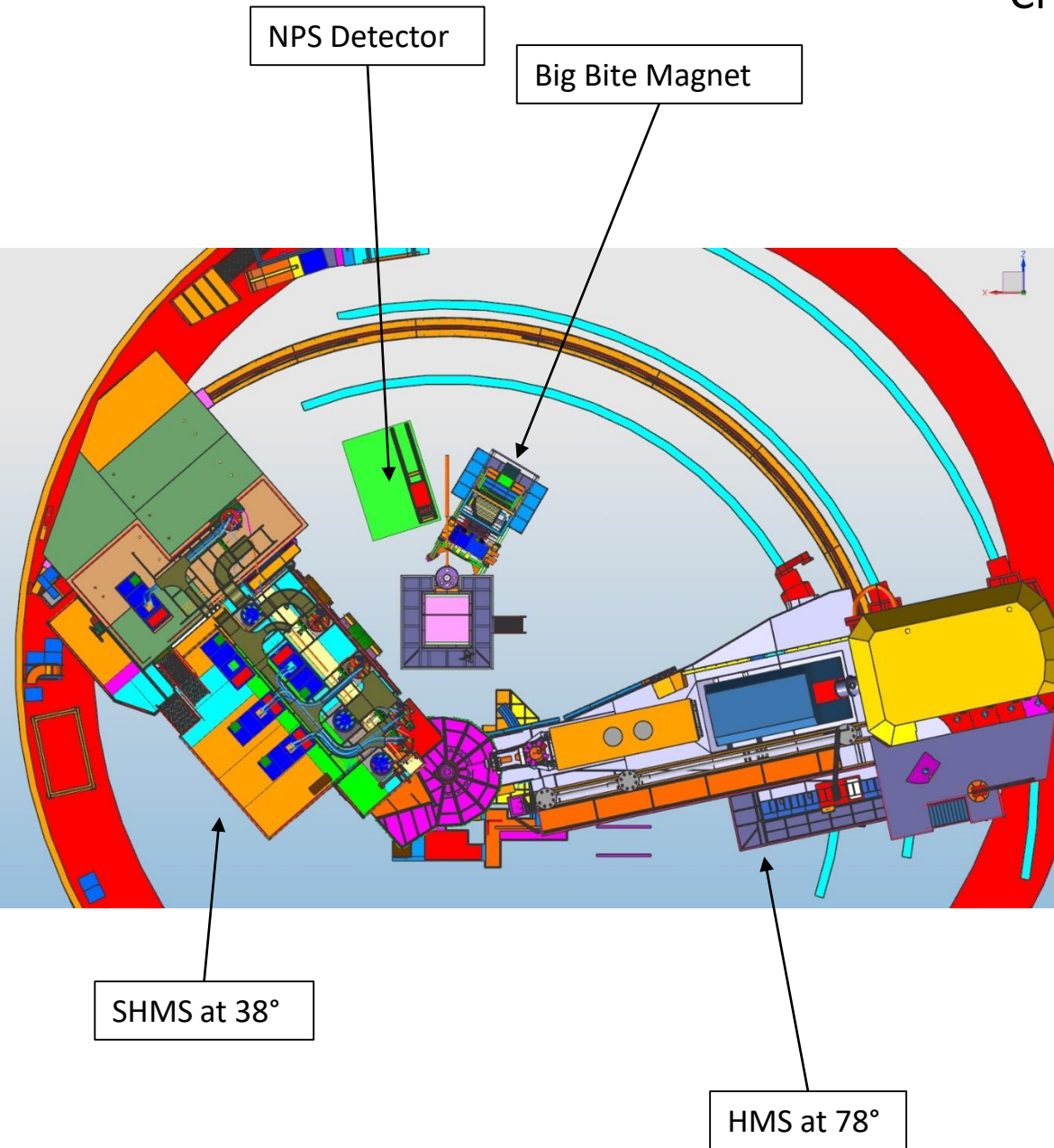
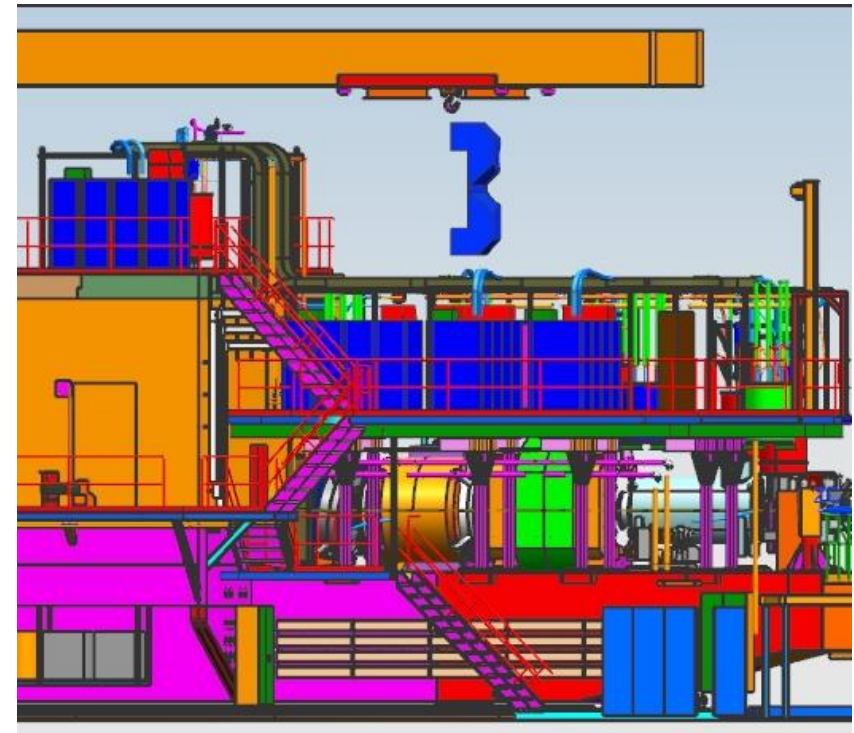

Optional for Big Bite Magnet to be lifted with a mobile crane

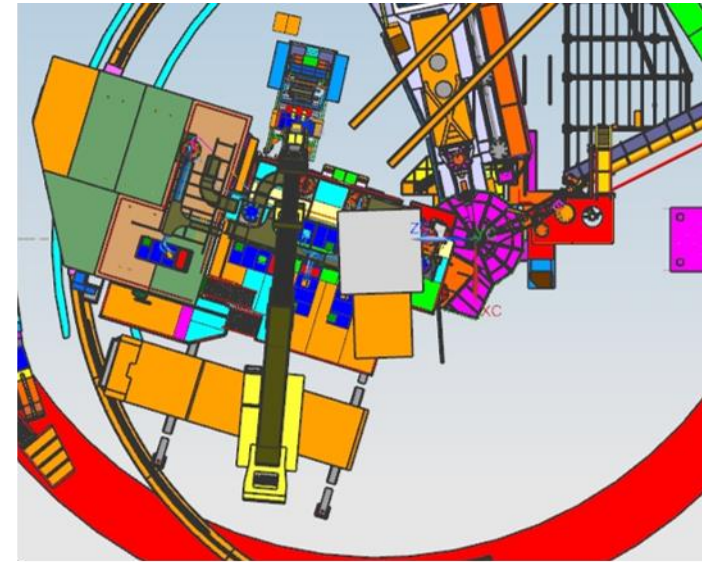

CPS Magnet Distances

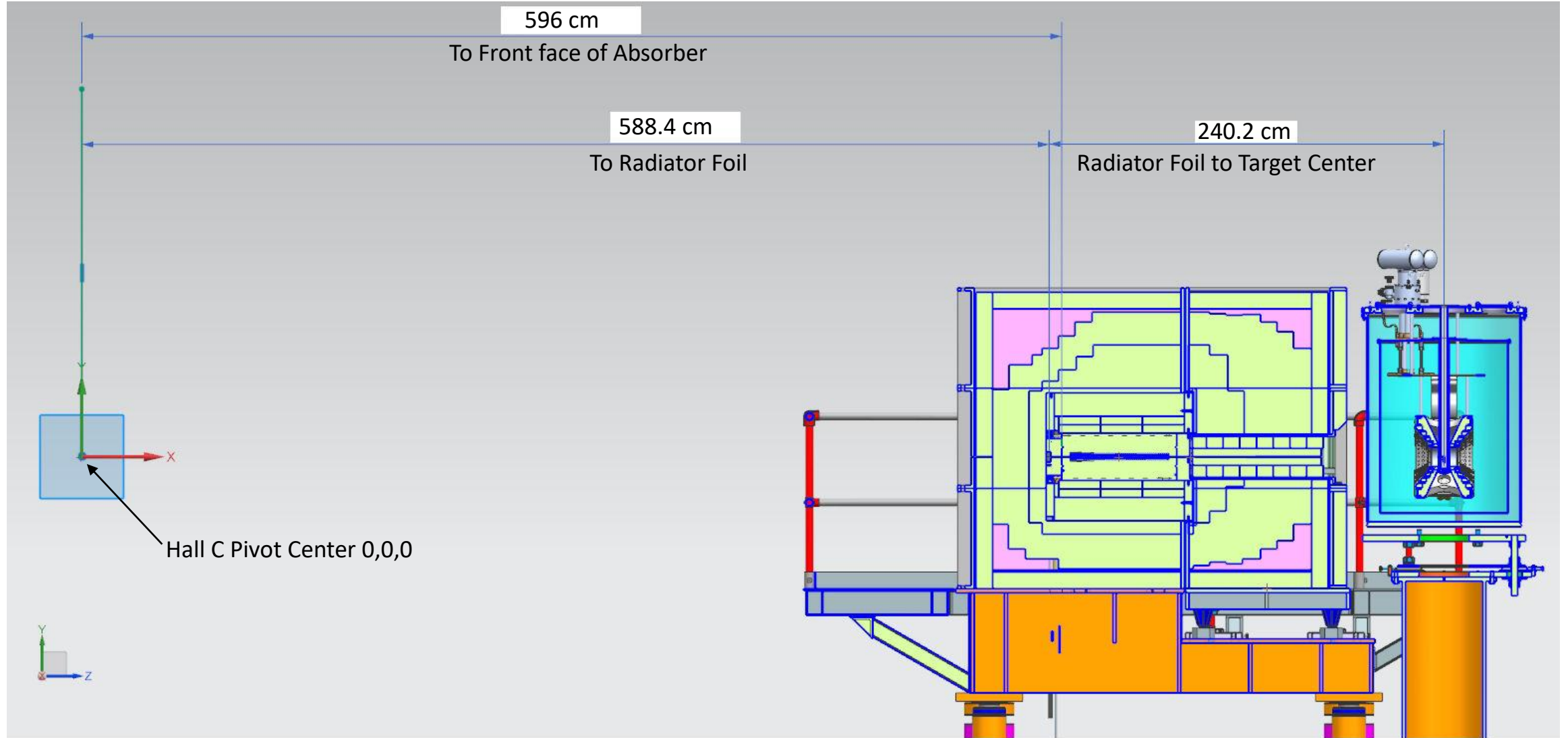

CPS in Hall C

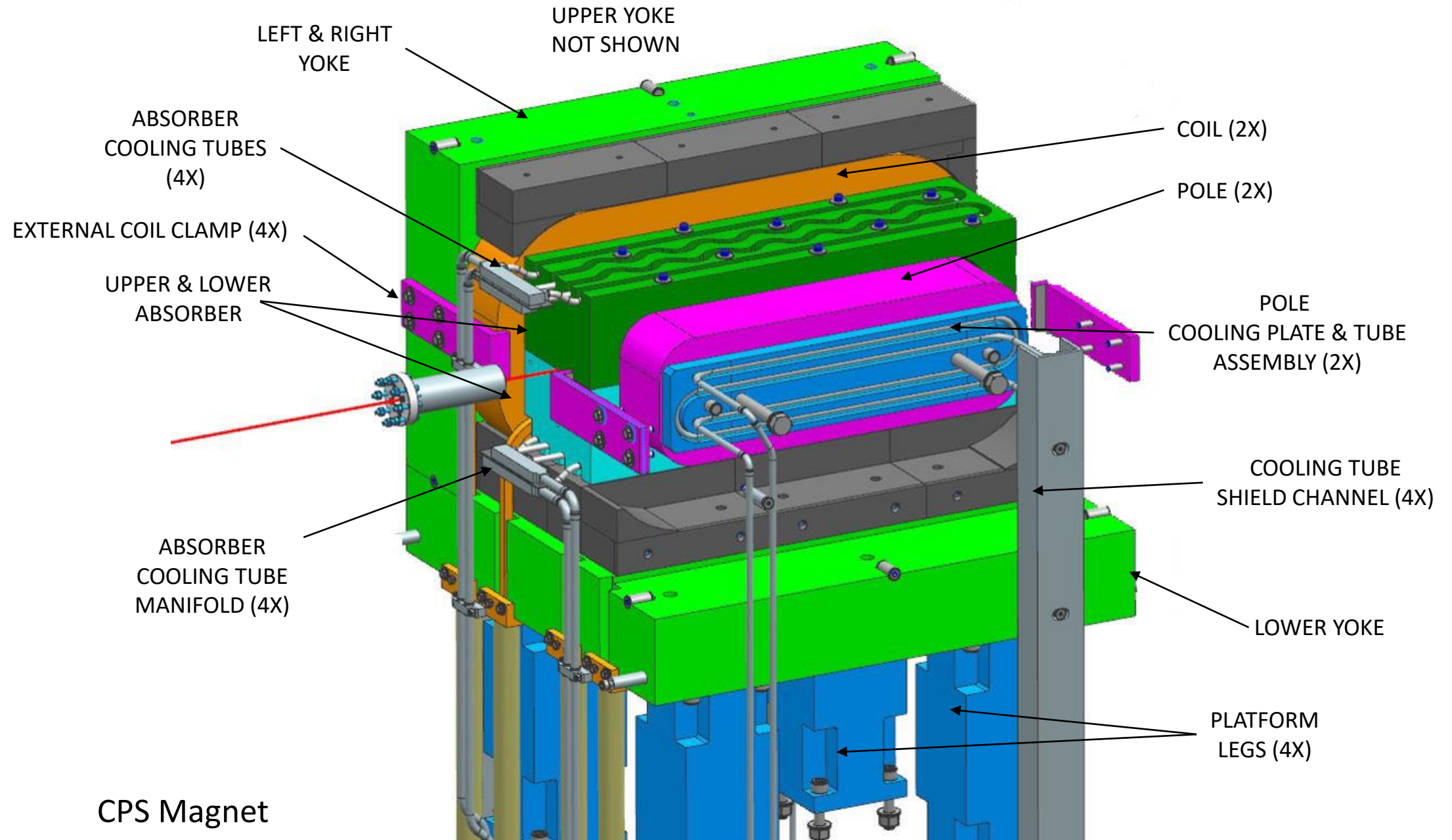

CPS Magnet

CPS in Hall C

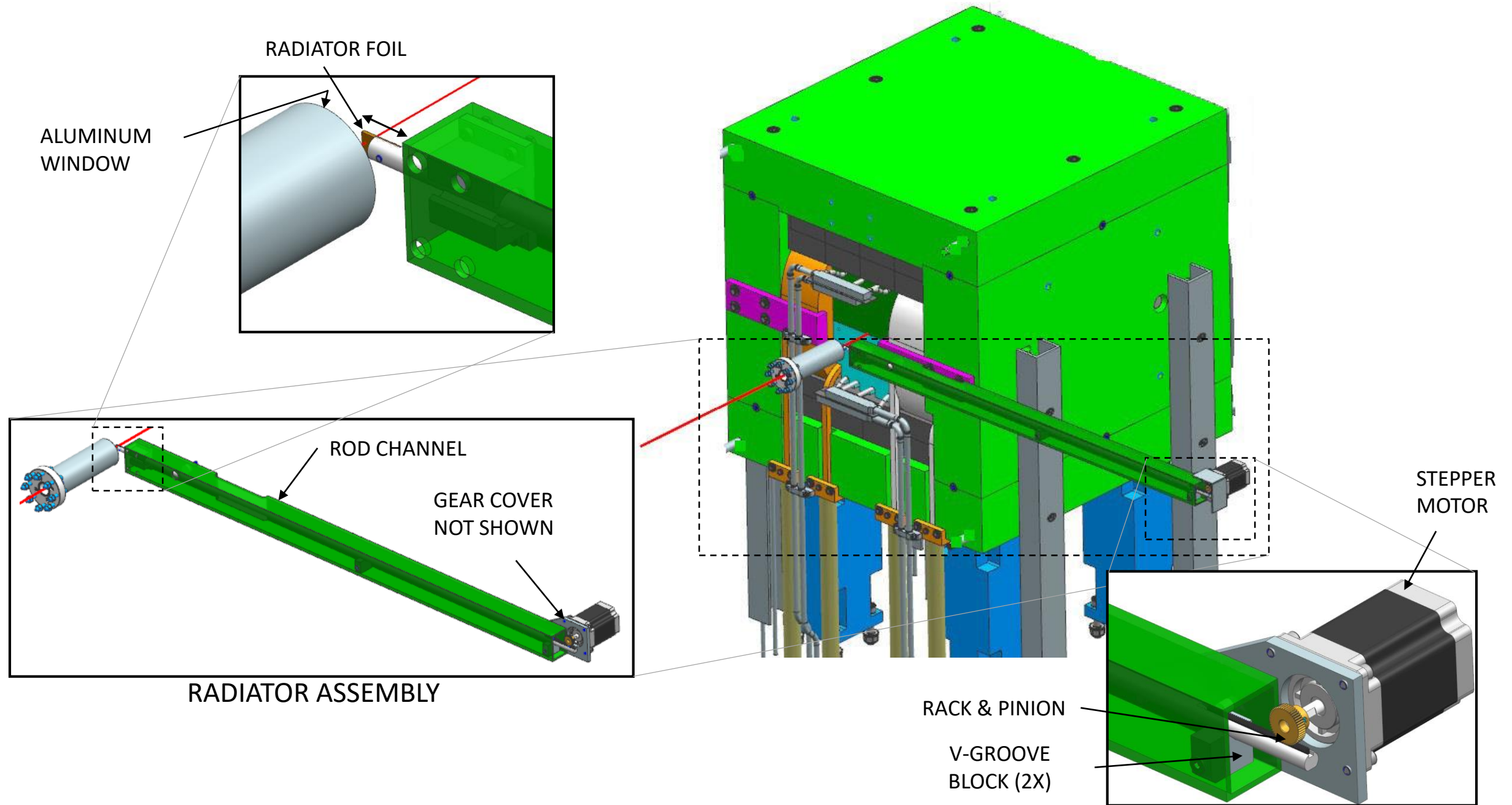

CPS Storage Location in Hall C

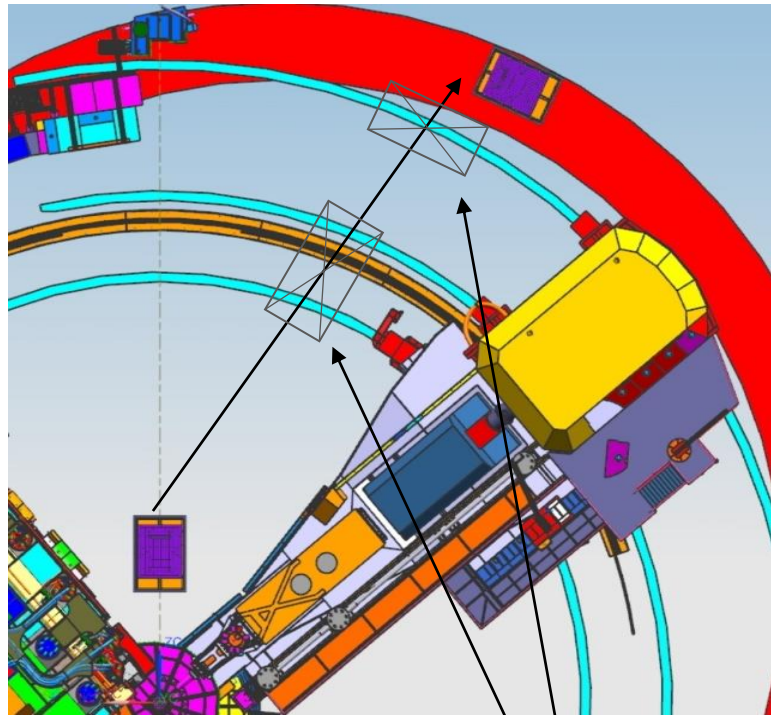

CPS moving to
storage location

Ramps to go over SHMS, HMS rails

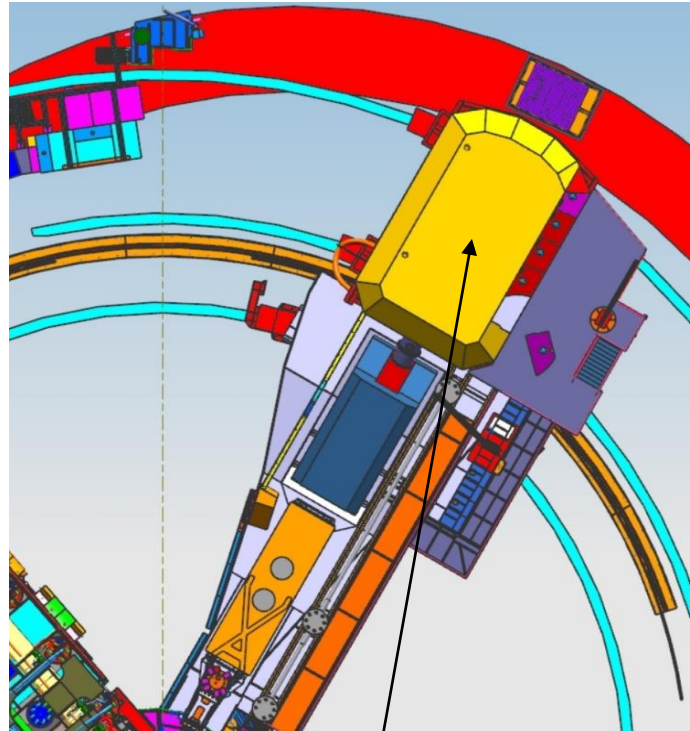

HMS shown at 30
degrees CPS in back

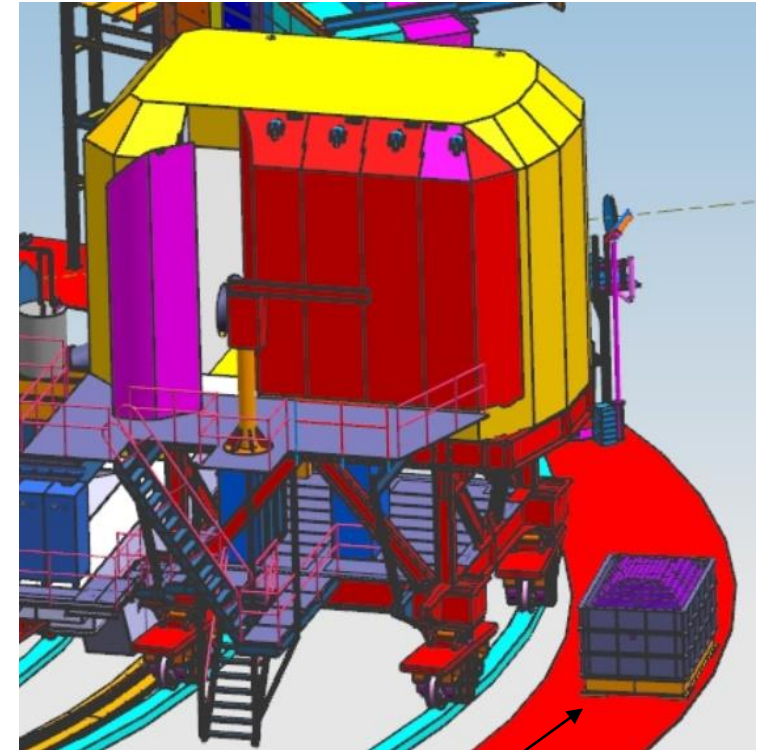

CPS in Storage Location

Tungsten Copper (80/20) 2" shielding added to magnet (Dark Gray)

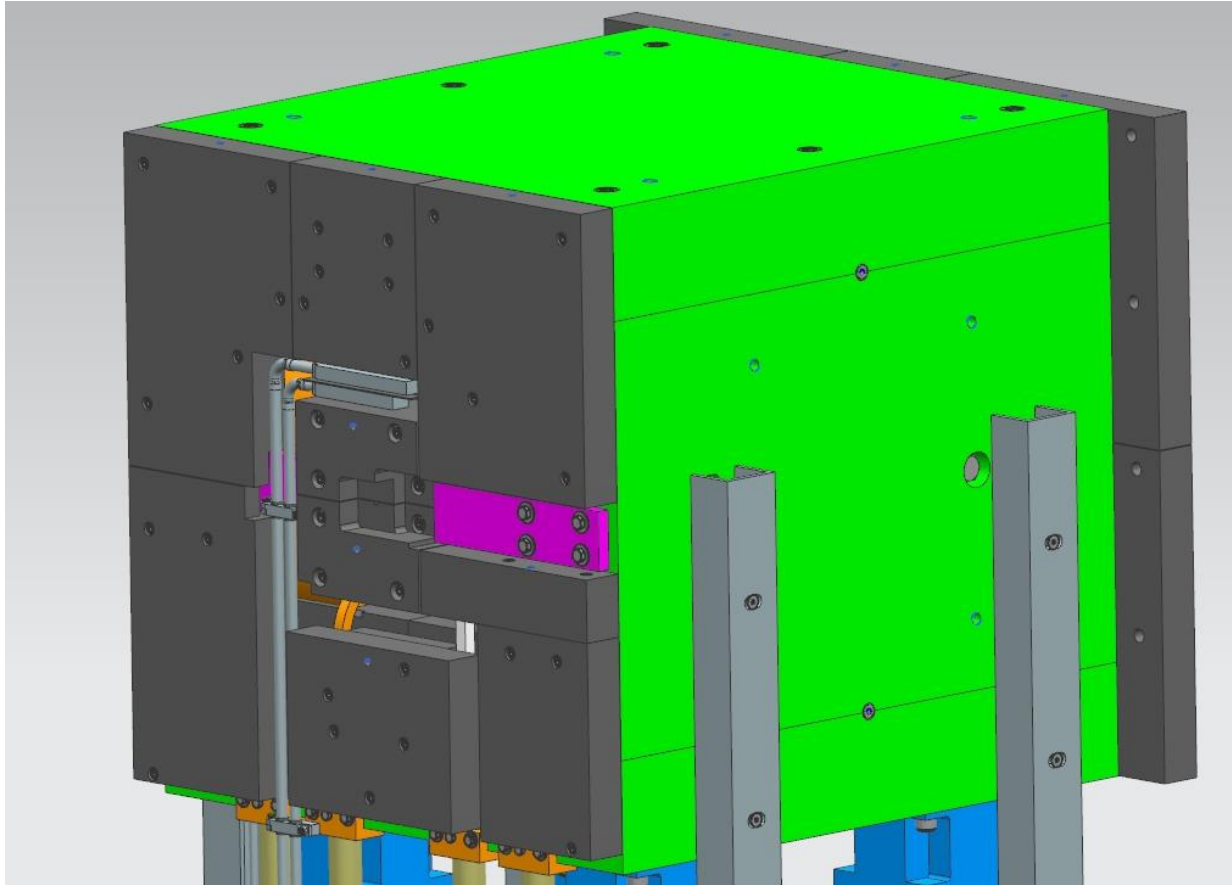

Upstream

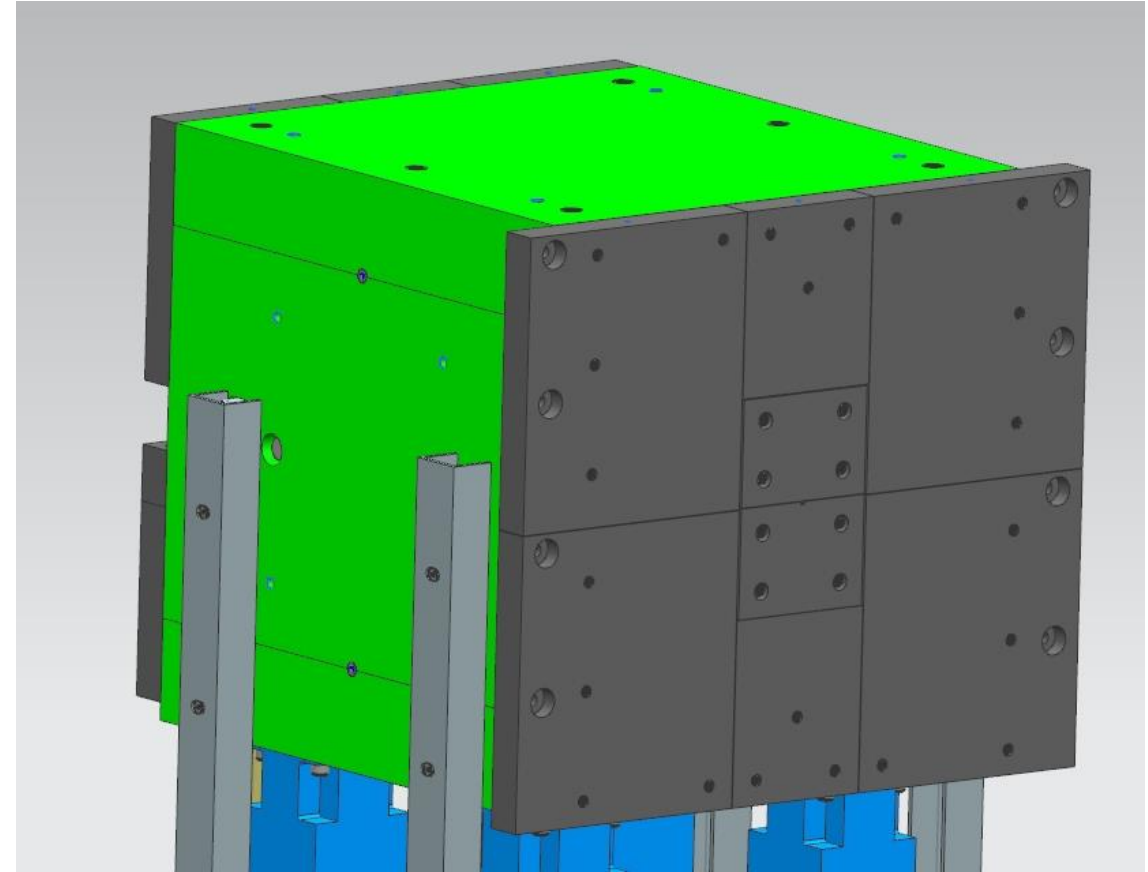

Downstream

CPS shielding platform assembly

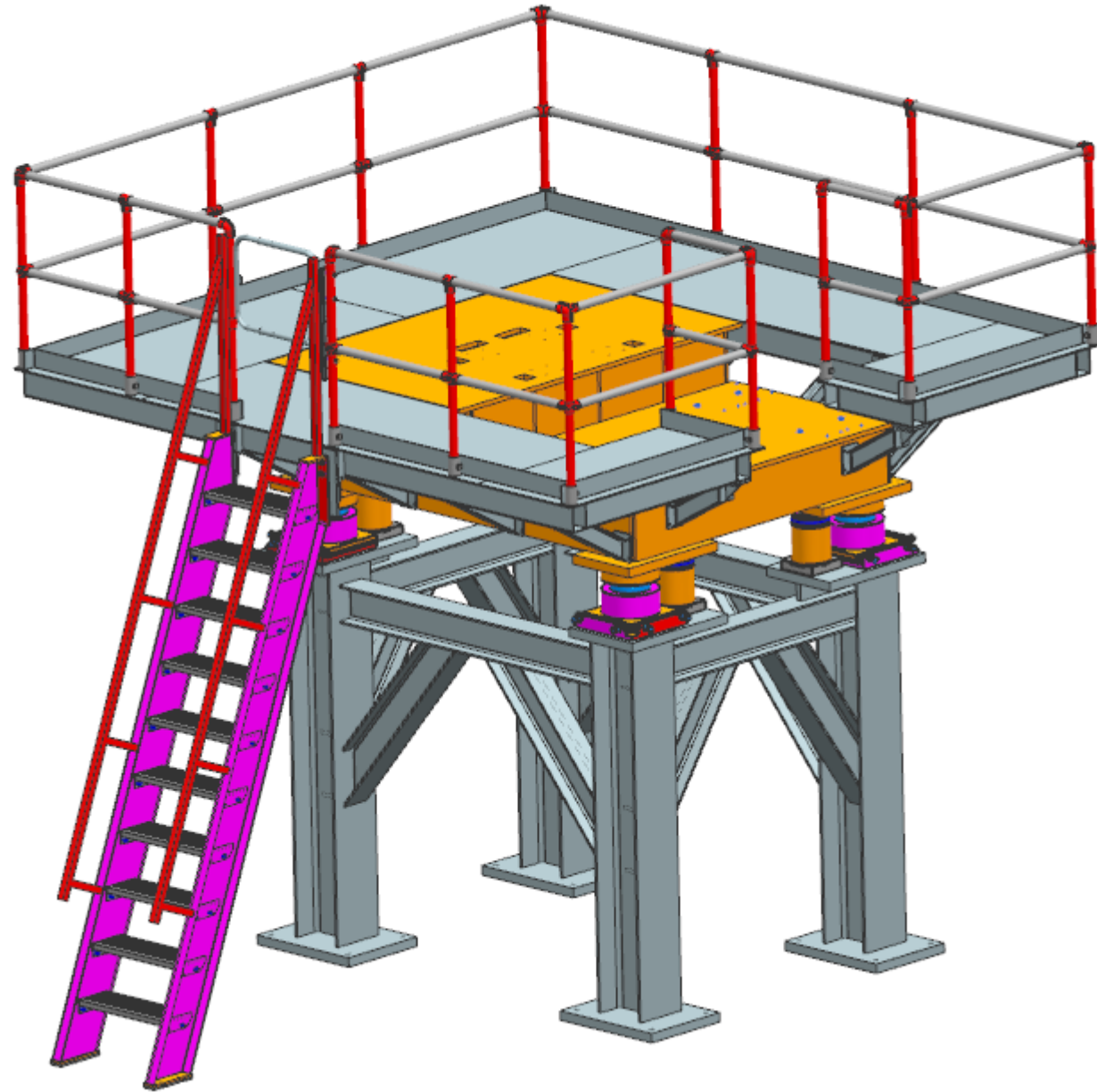

Side cross section of CPS shielding

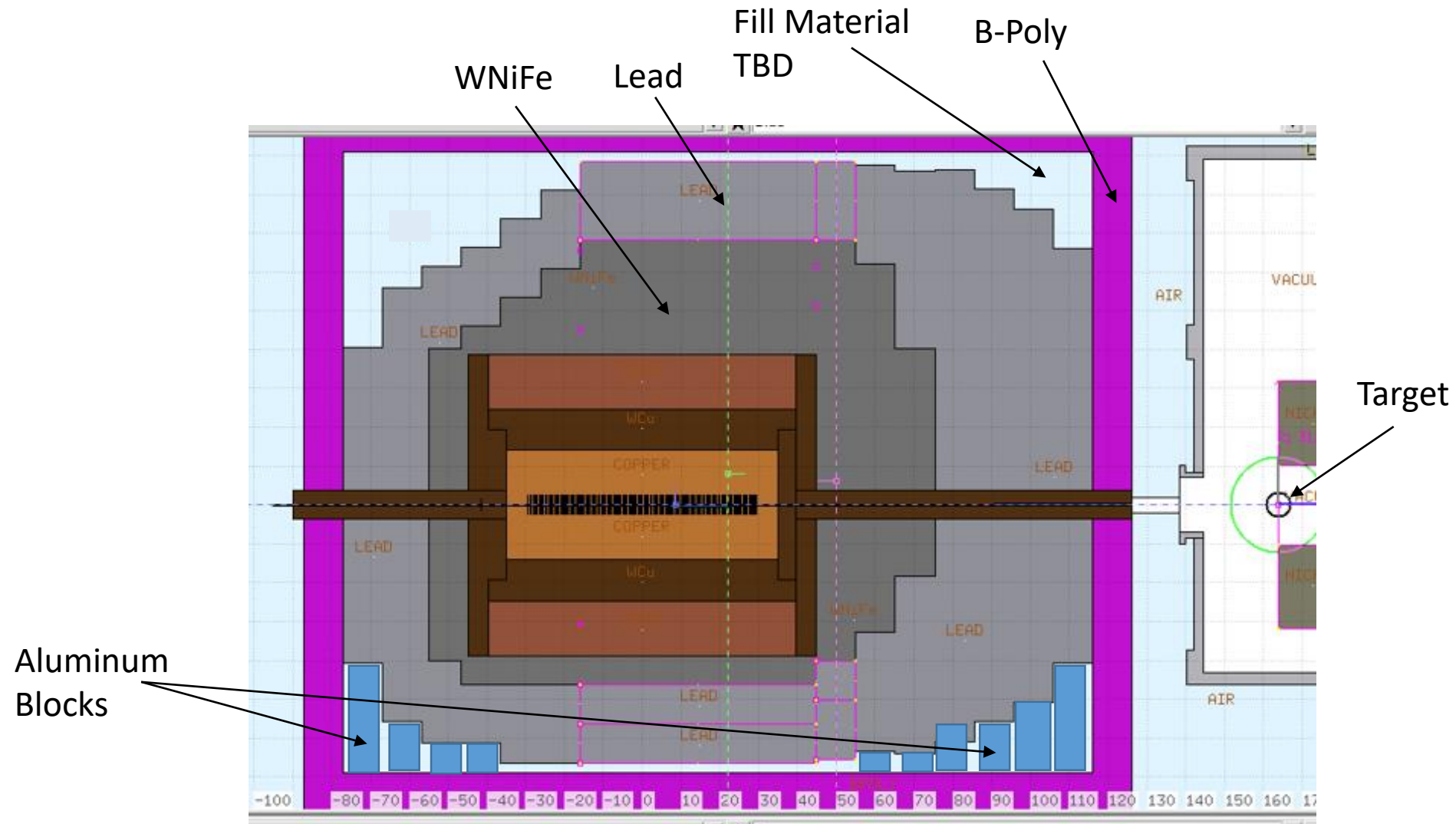

B-Poly Sheet with .5" Aluminum sheet

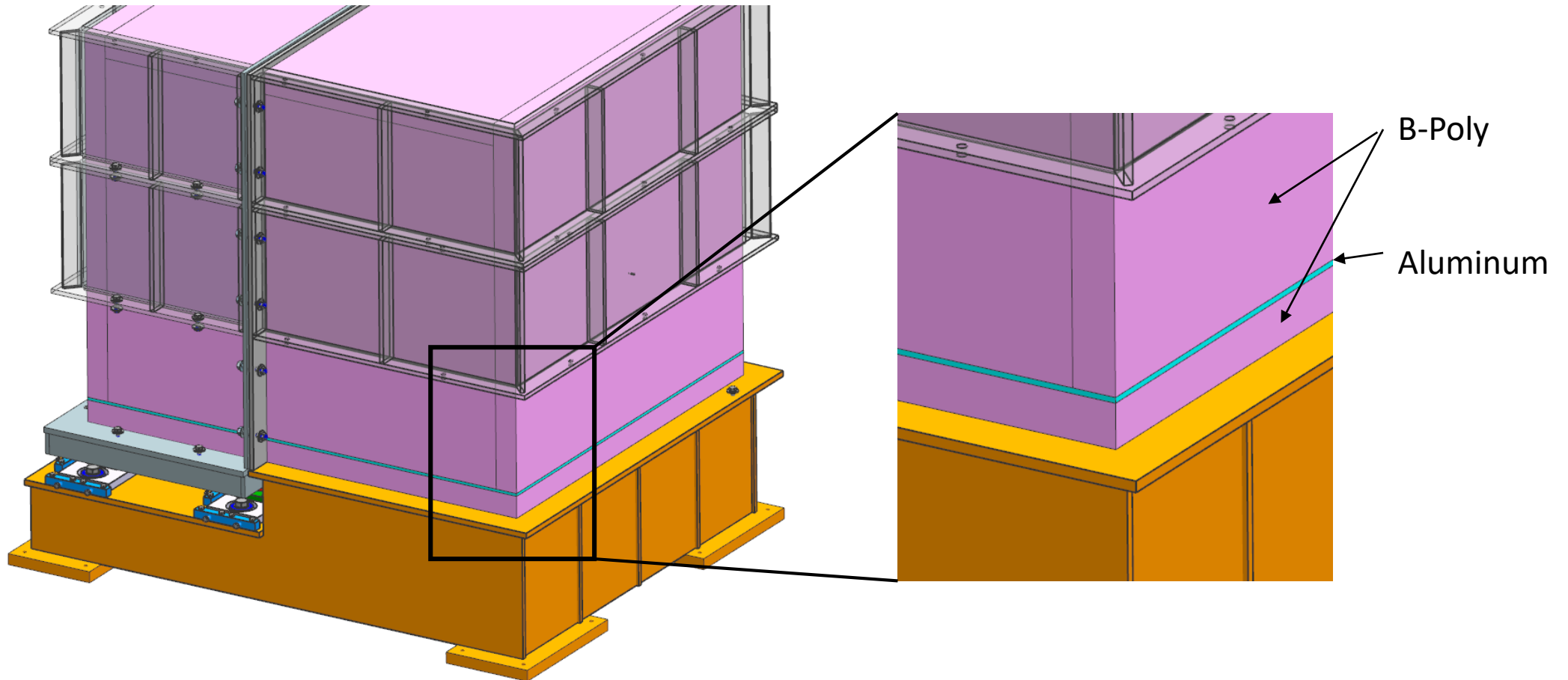

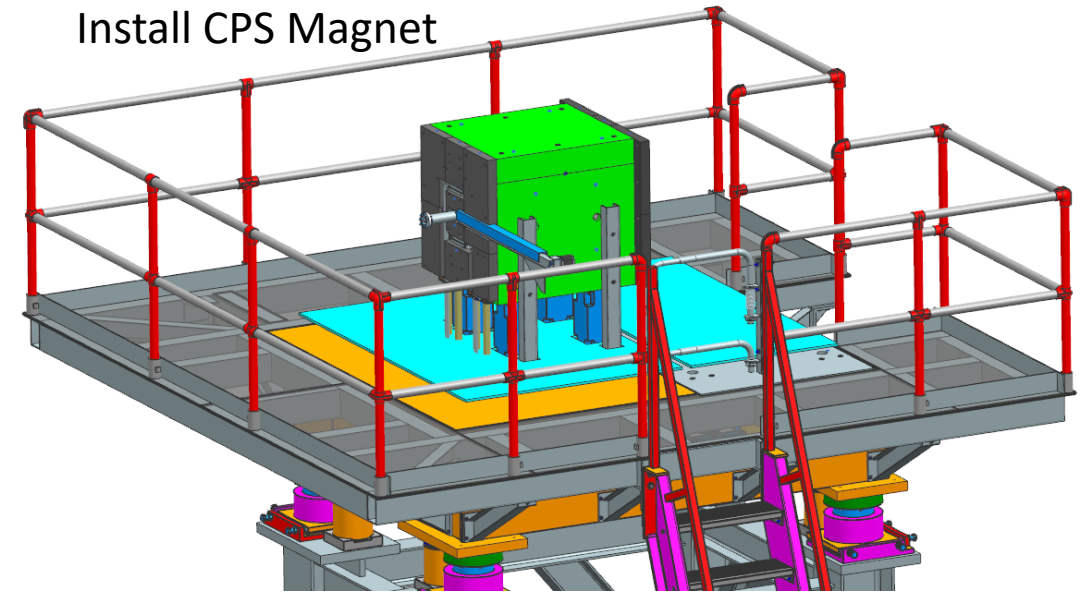
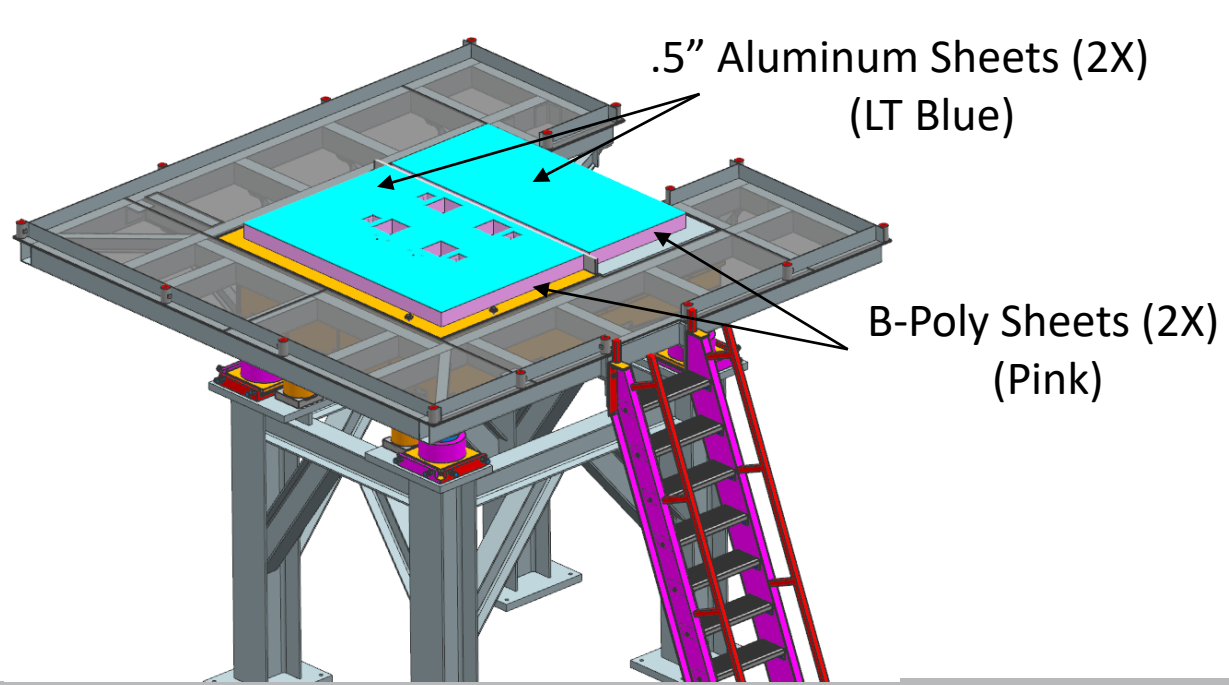

Install Lower Shielding Wall

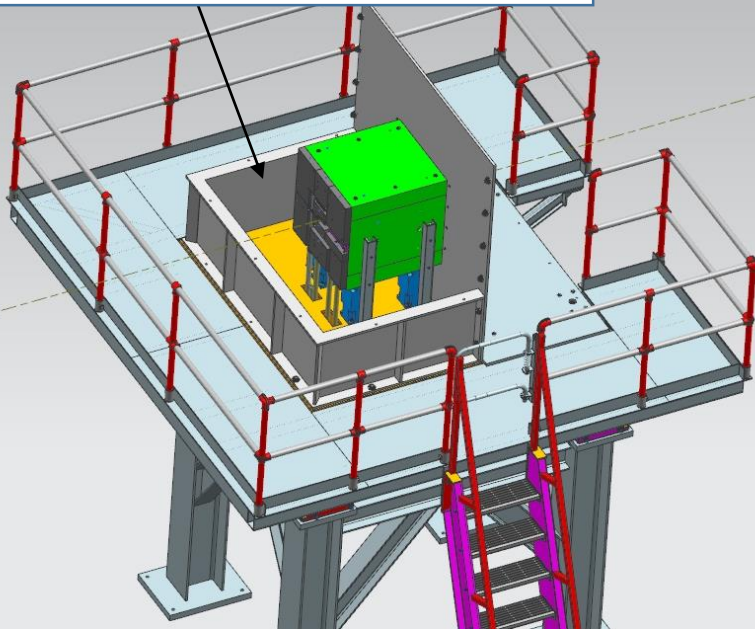

Install Lower B-Poly Sheets

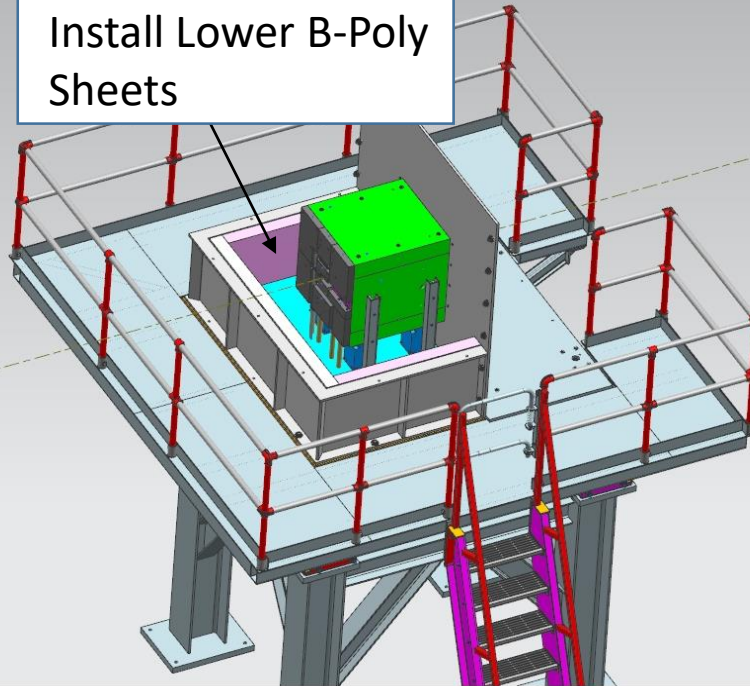

Add Aluminum Spacer Blocks to support Lead & Tungsten Bricks

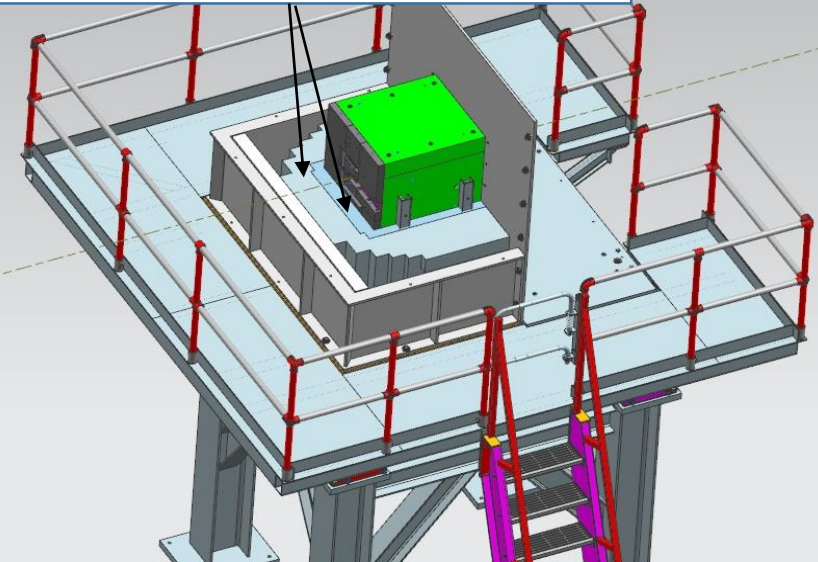

Add Second Layer Wall and Load B-Poly and Bricks

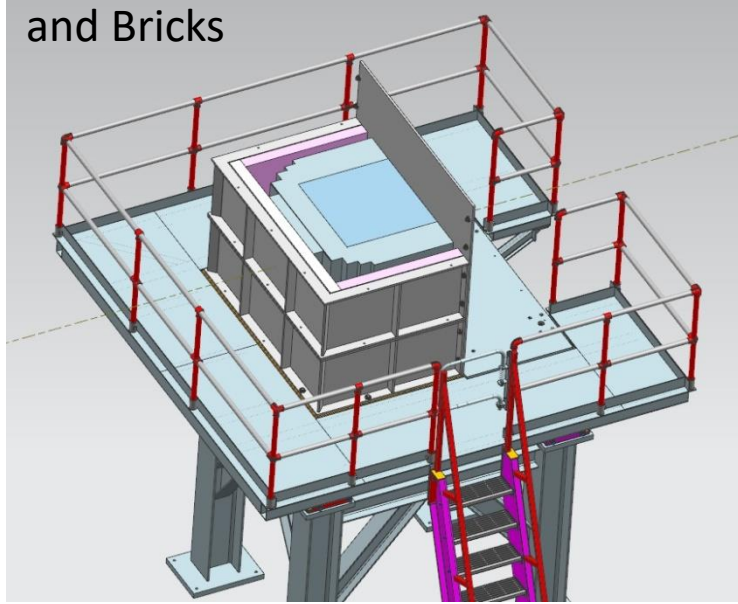

Lead Tungsten

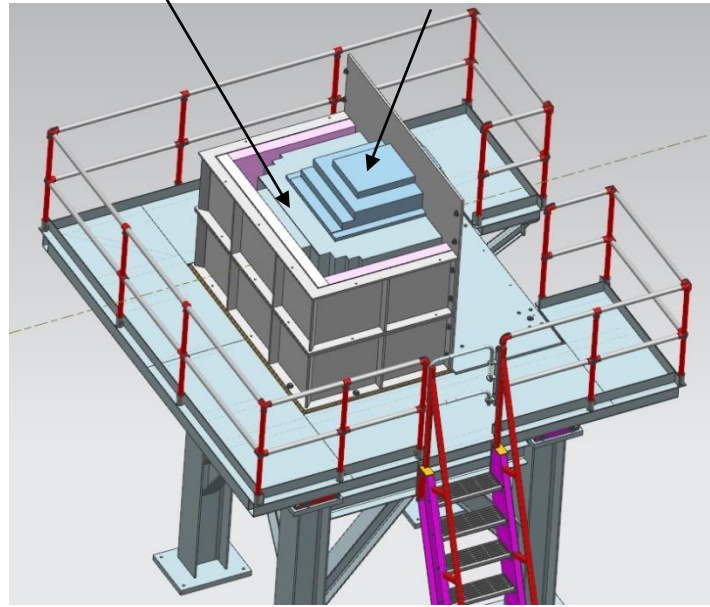

Finish adding Lead and ...

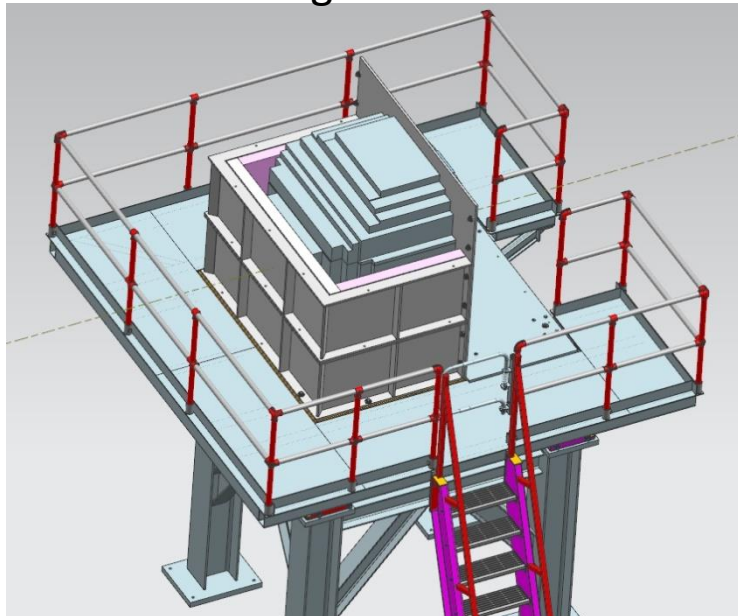

Add Third Layer and cover with b-poly

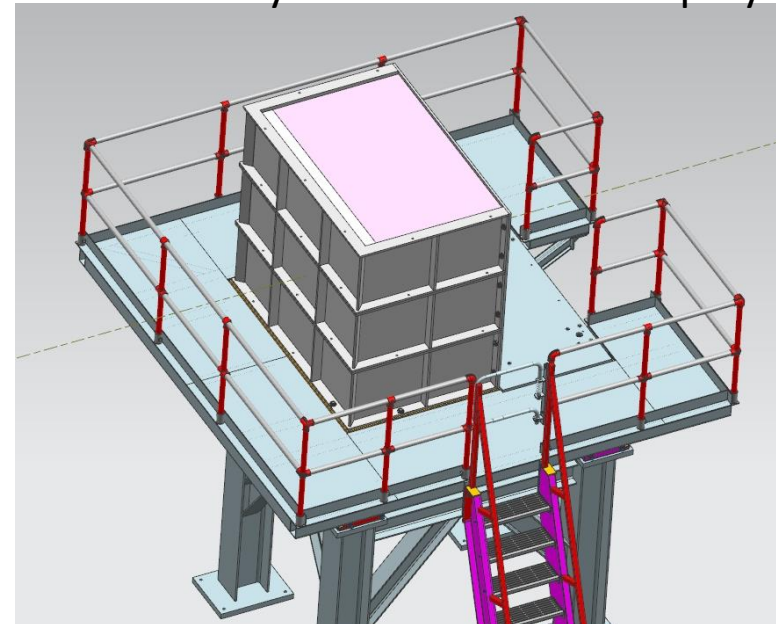

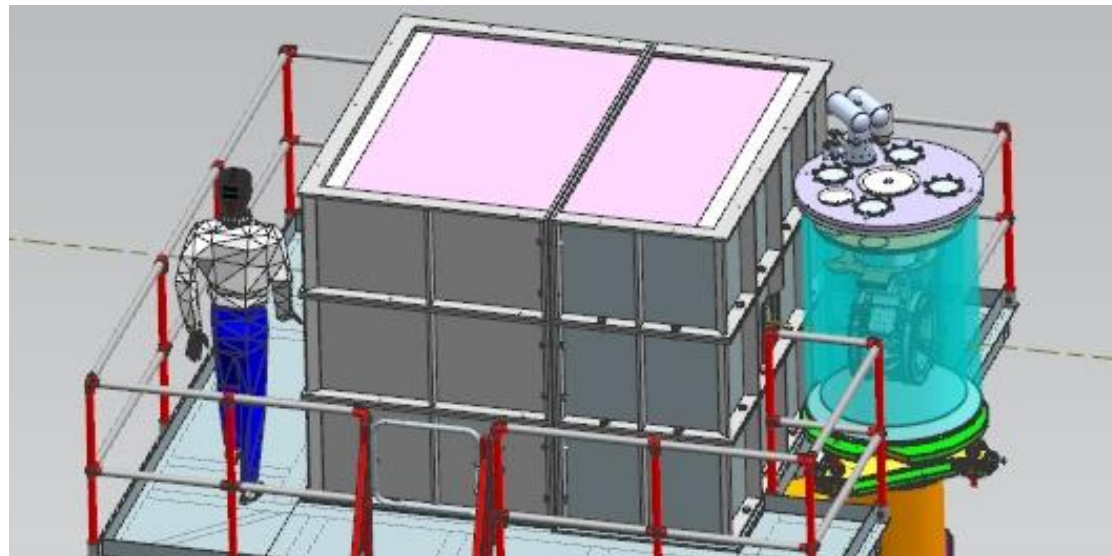
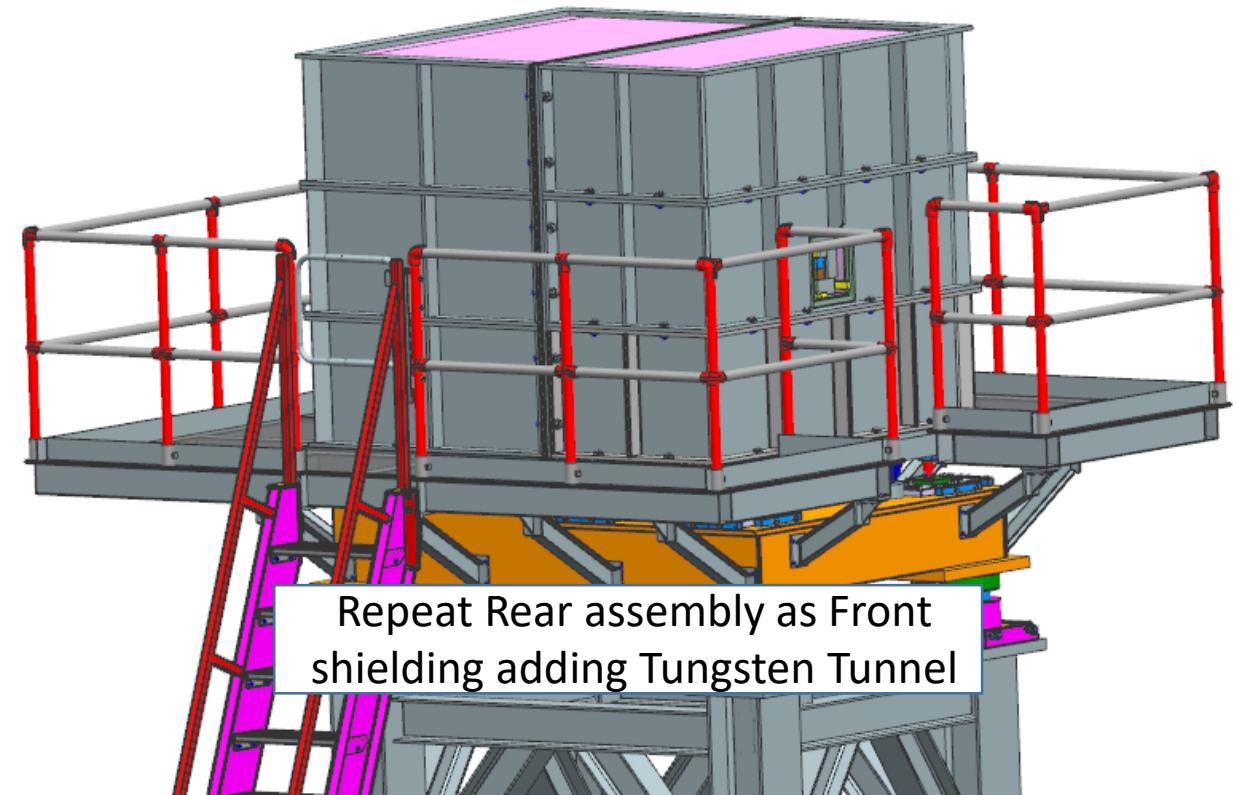
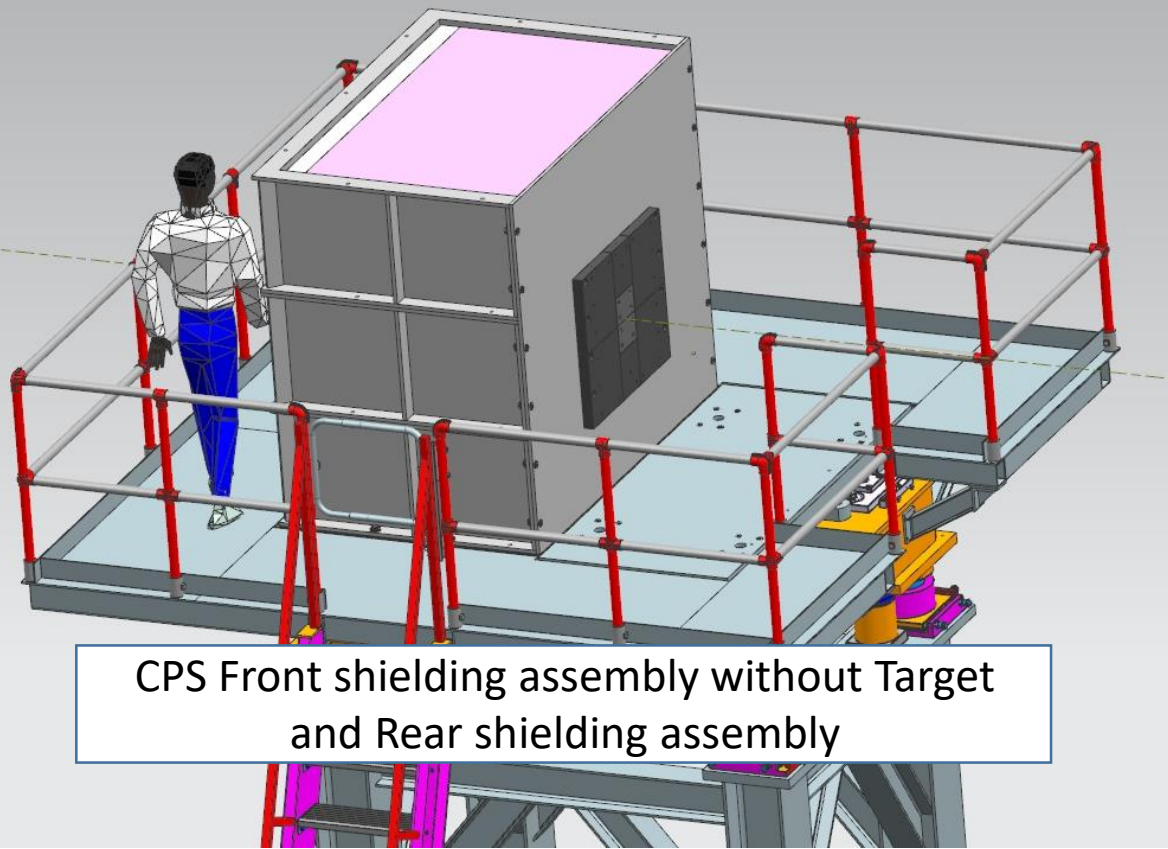

Target position to CPS

CPS 3mm to 6mm Tungsten Tunnel

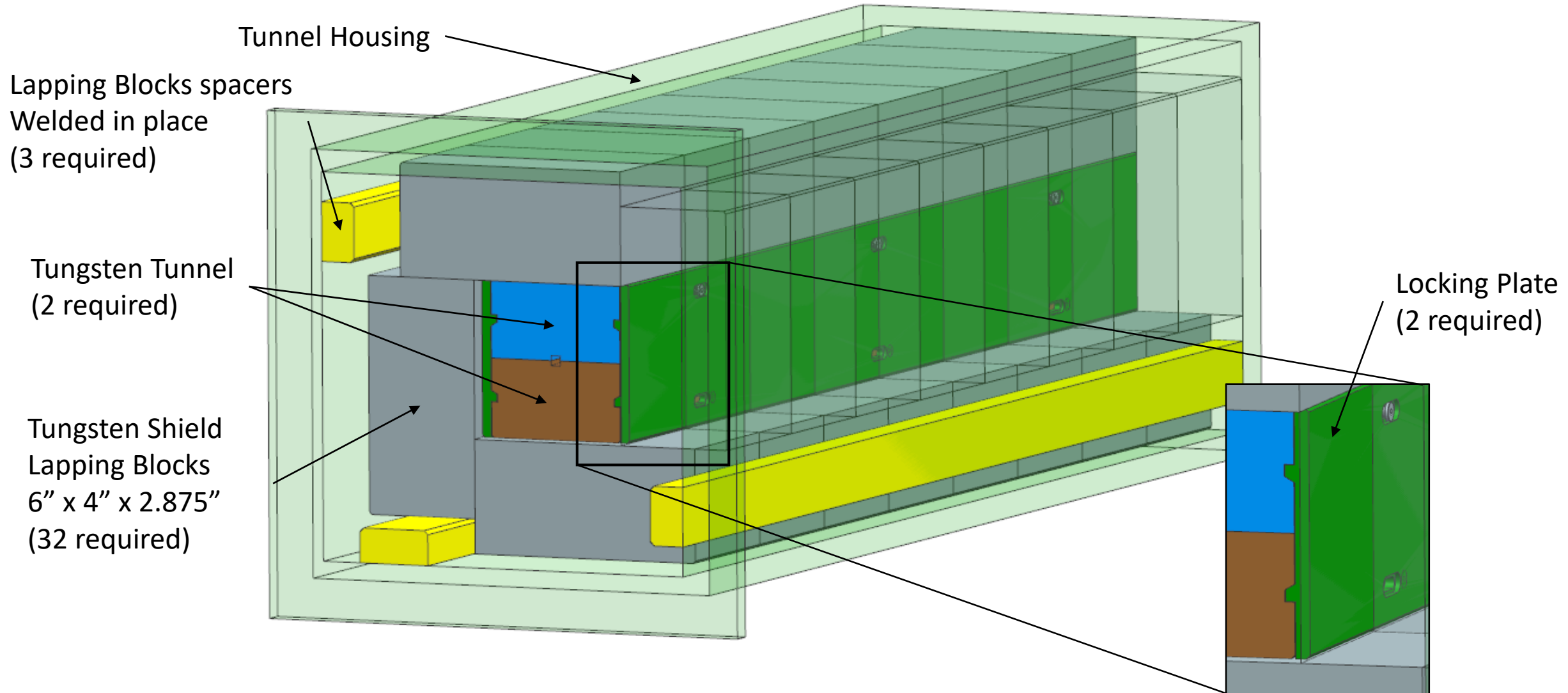

CPS 3mm taper to 6mm Tungsten Tunnel

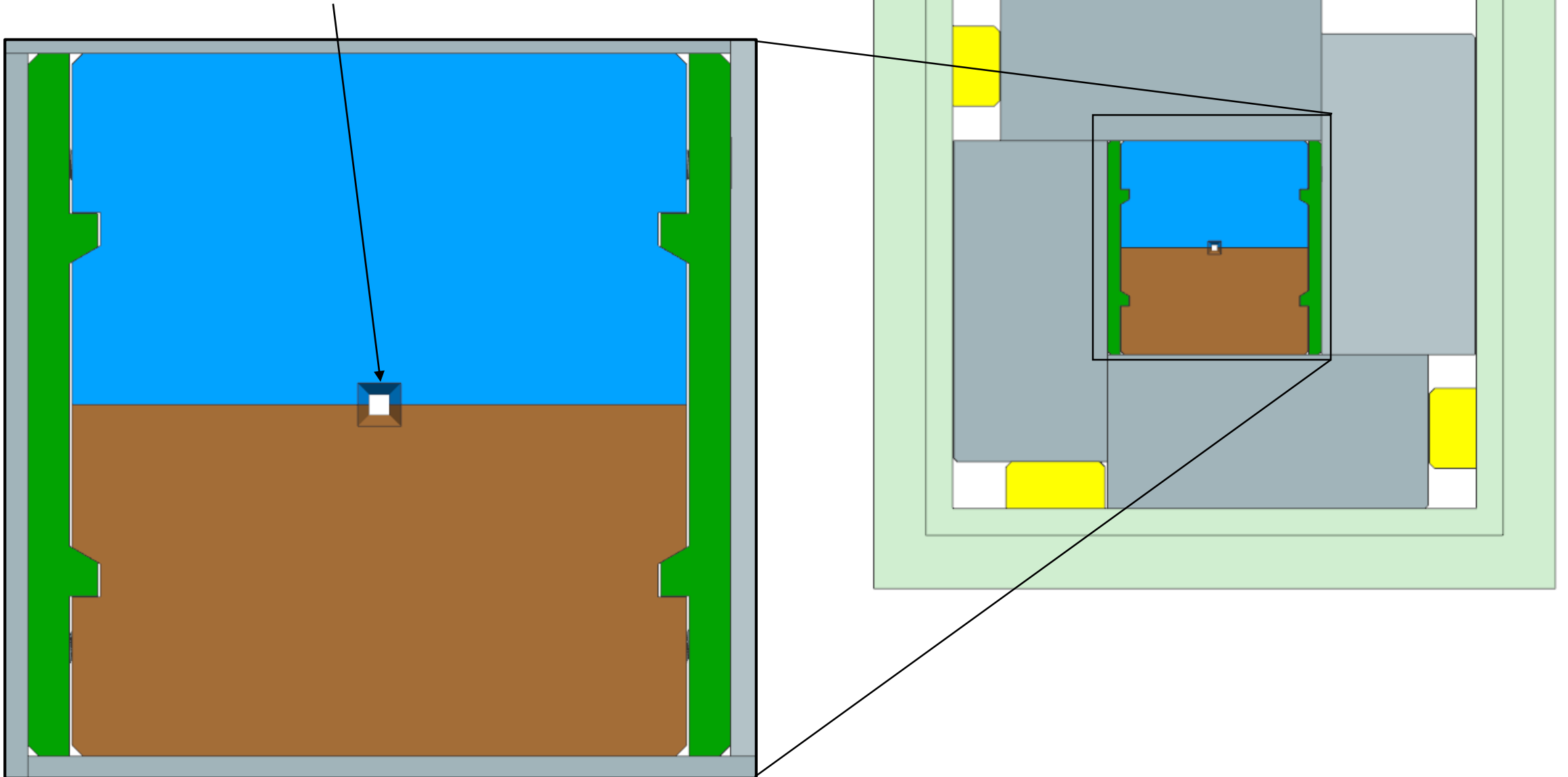

Rear Shielding
Magnet Plate

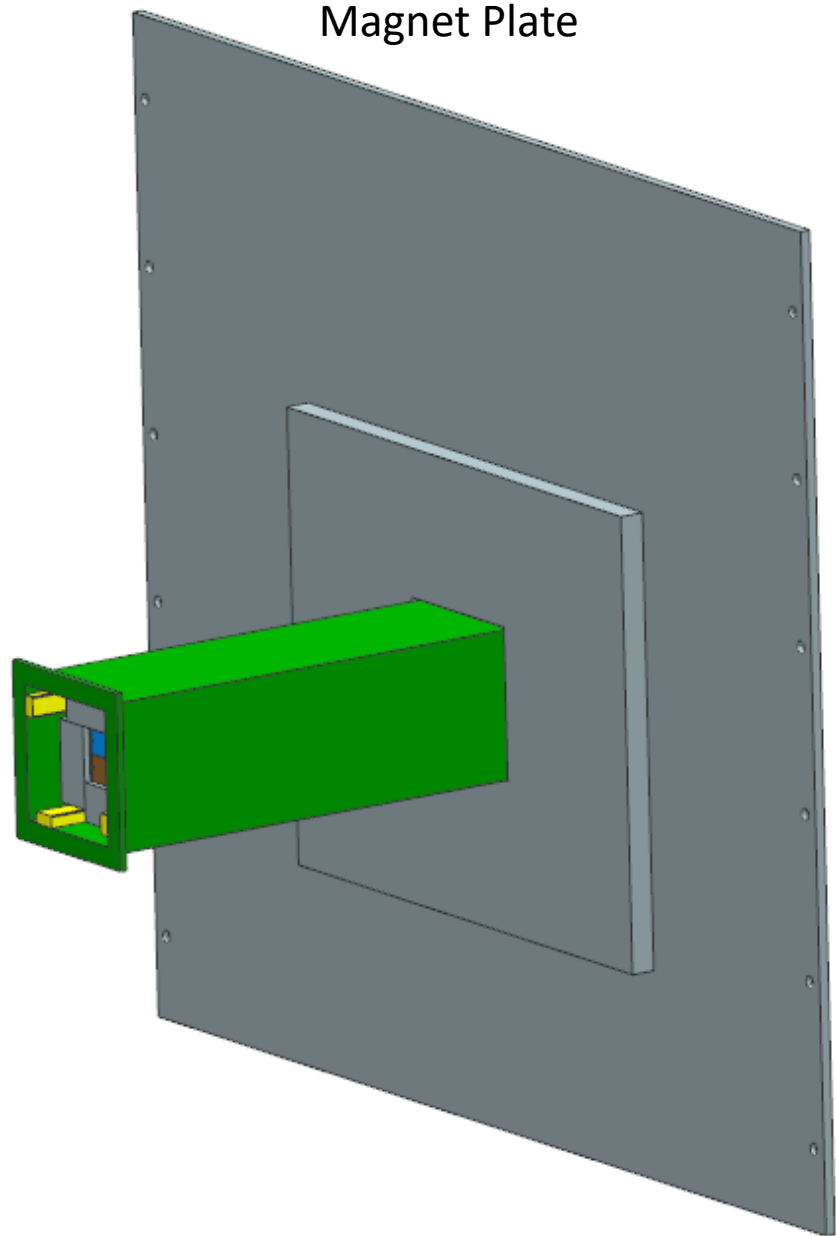

Rear Tungsten Brick

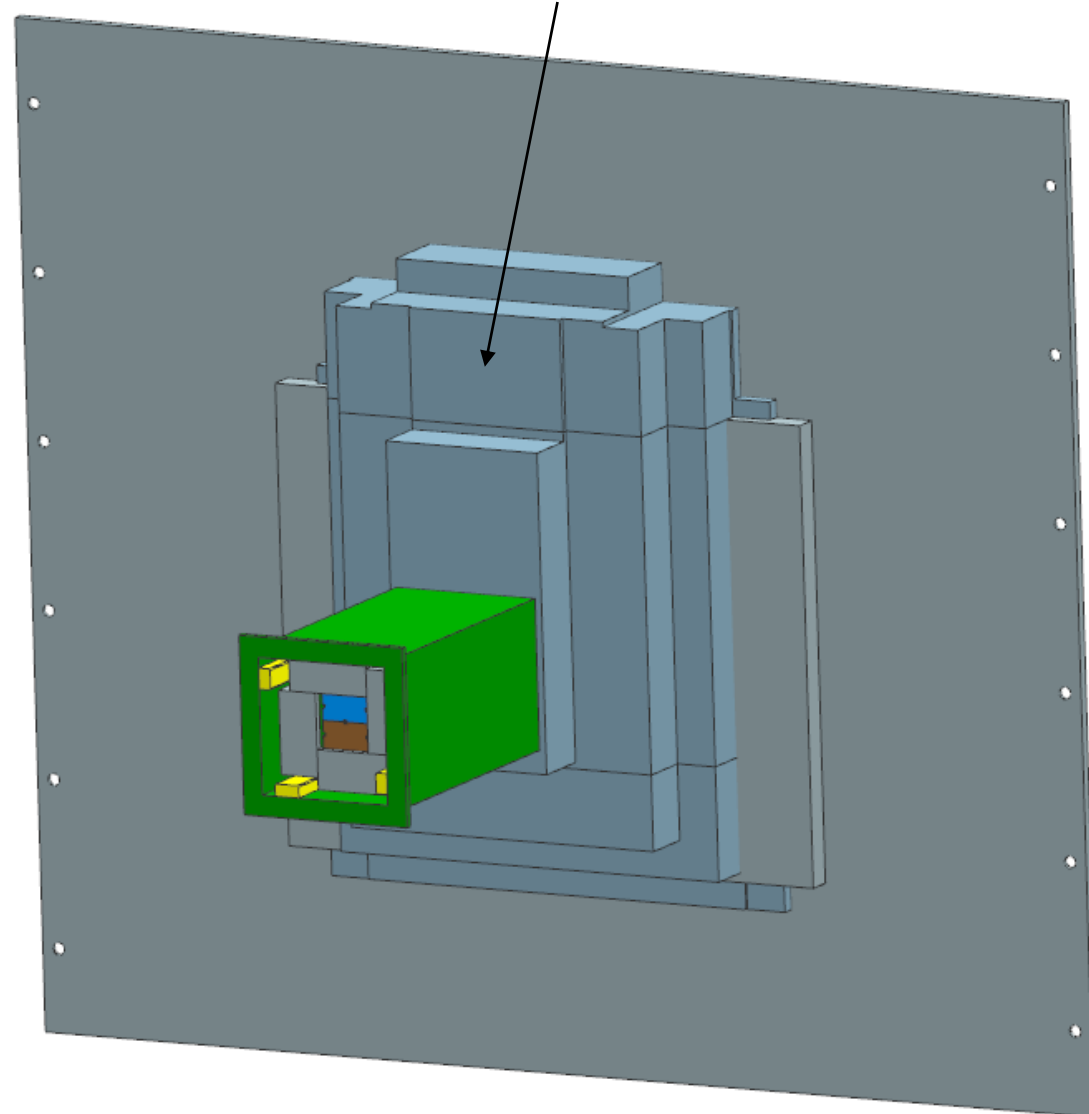

Rear Lead Bricks

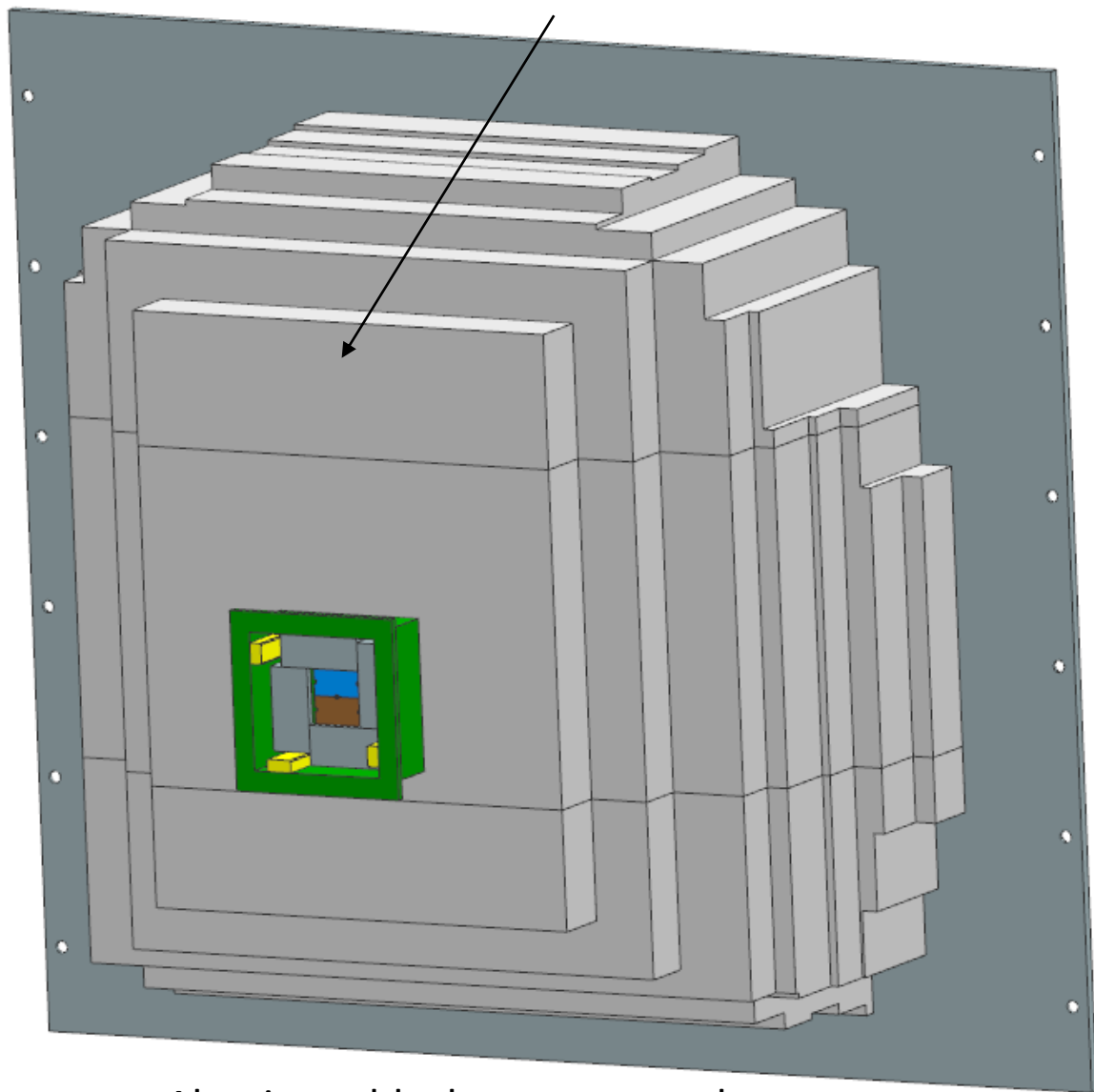

Aluminum blocks to support the
lead bricks (Not shown)

B-Poly Sheets

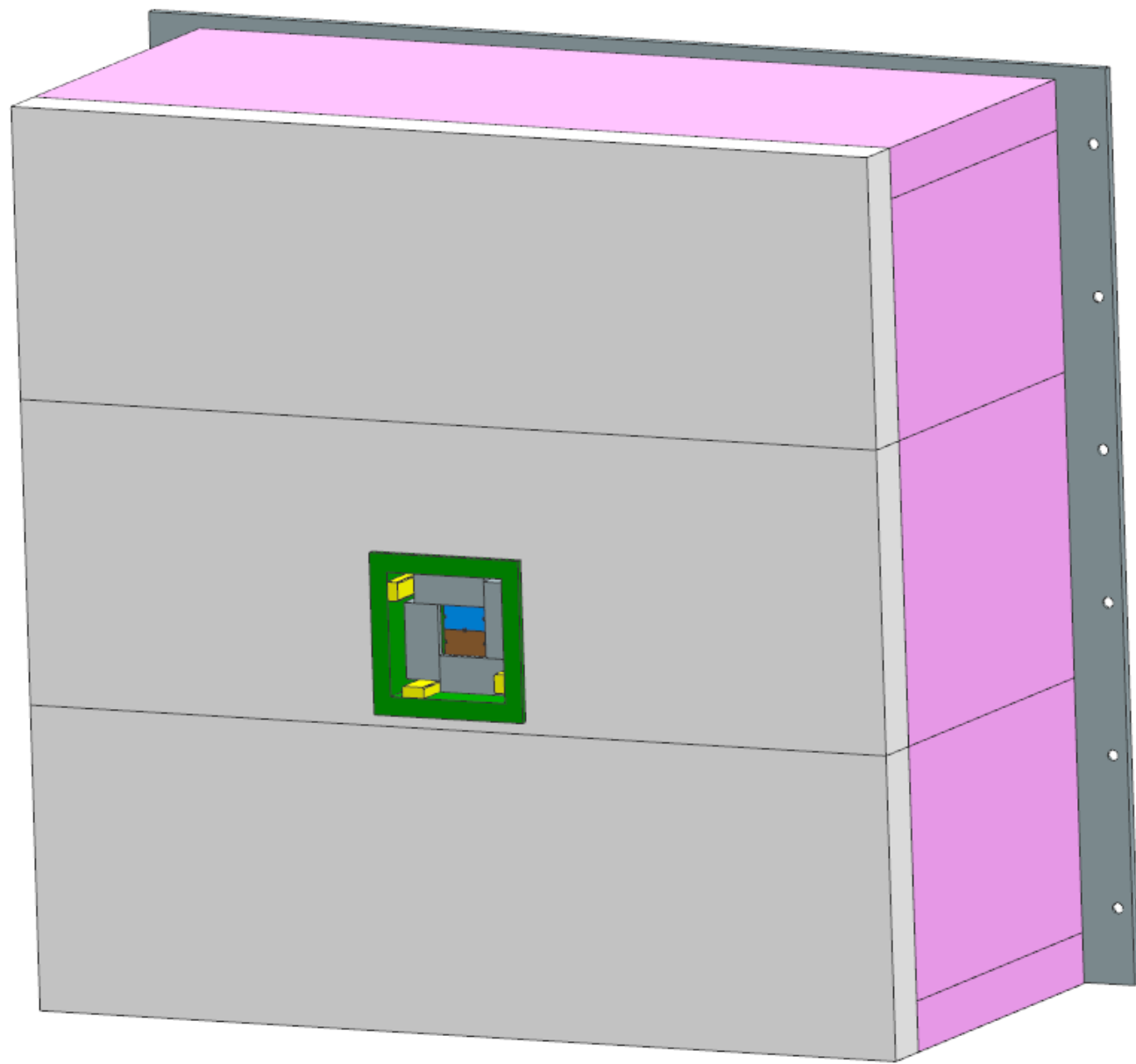

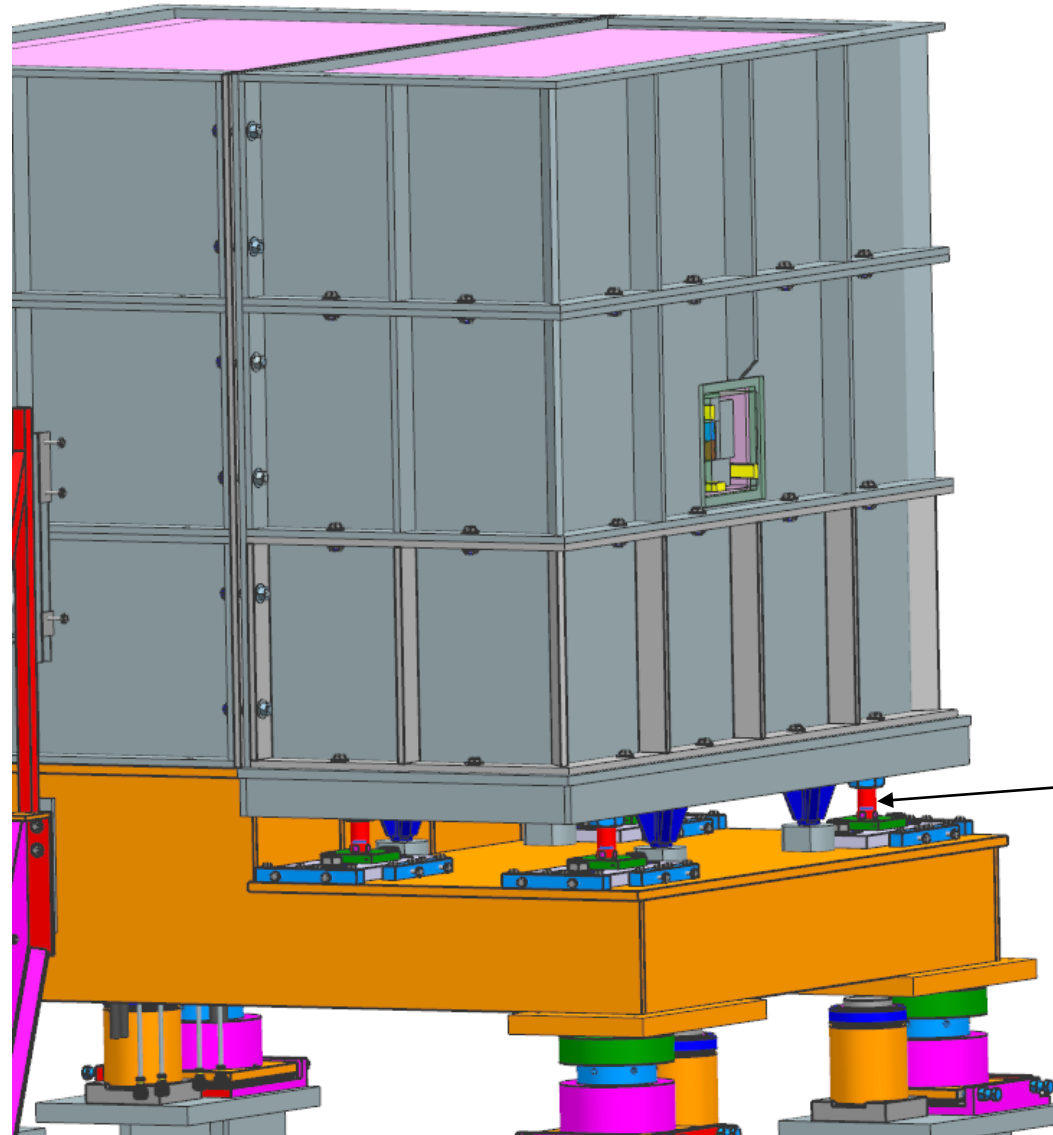

Rear Shielding independent
of Front Shielding using lifts
and Jacks

Rear Shielding Assembly

