

Vitroly Magnet
ORIGINAL

3/17/2023

AA MAGNET
NEW

A. Williams

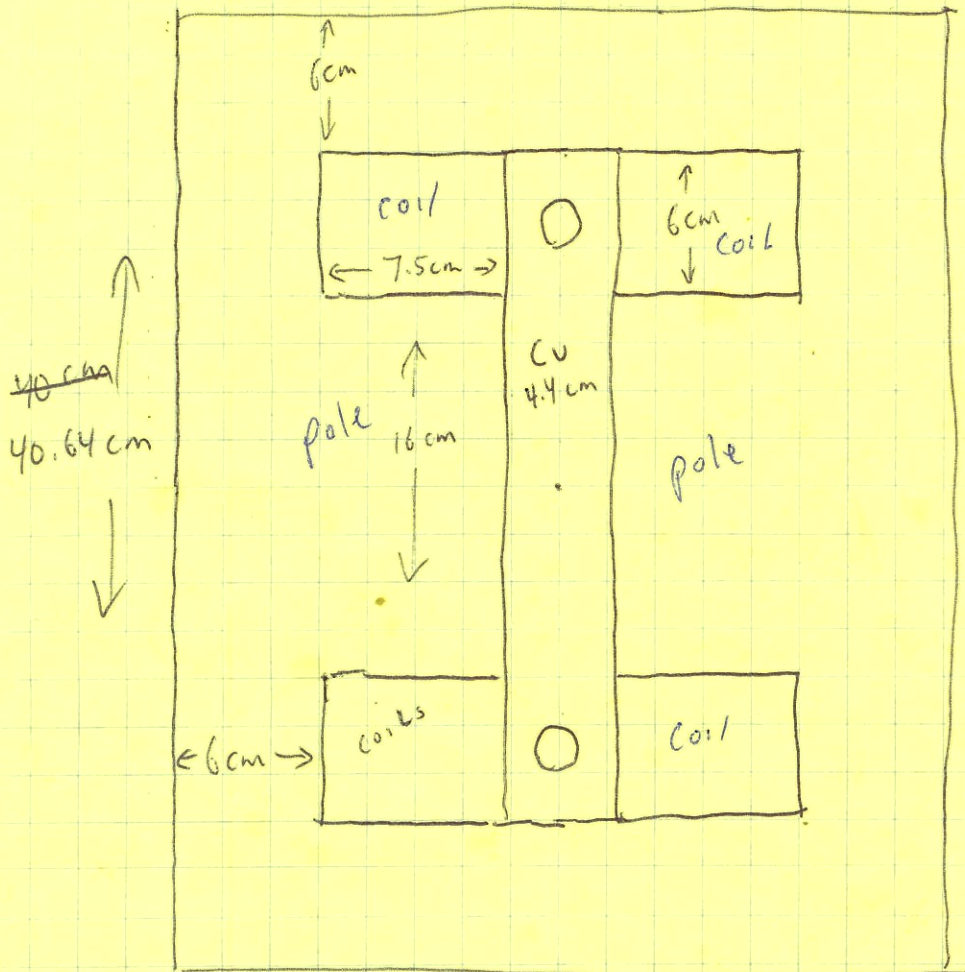

31.76 cm
~~34.76 cm~~

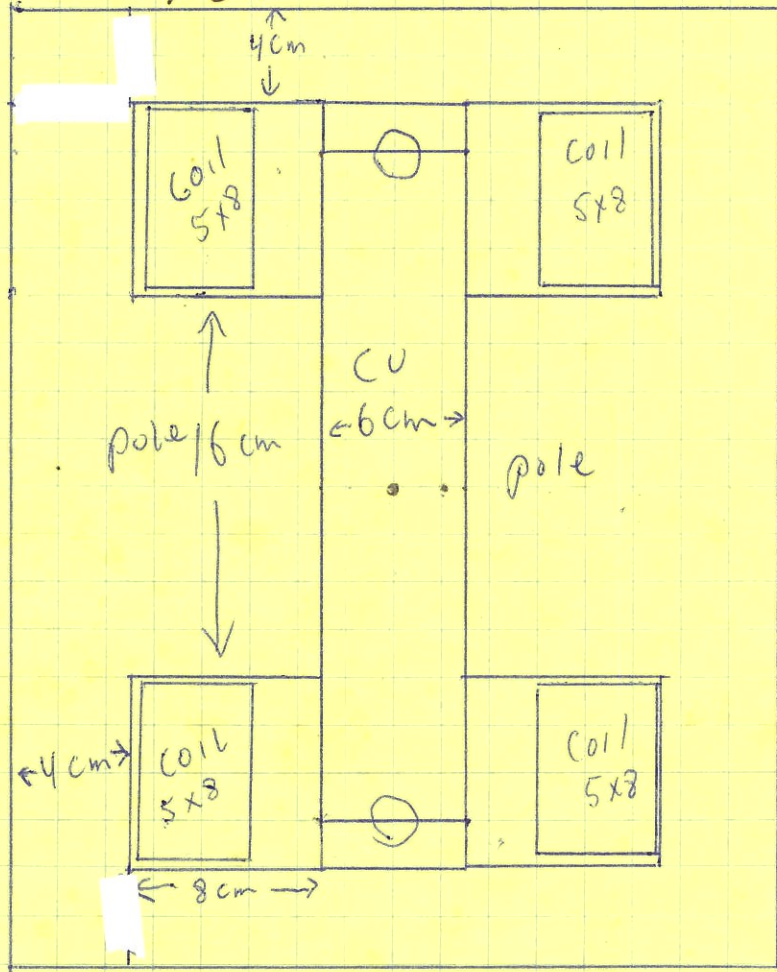

40 cm

$L_{pole} = 0.6 \text{ m}$ 30 cm
 $N = 40 \text{ Turns}$
 $V = 40 \text{ V}$
 $I = 270 \text{ A}$
 $BdL = .132 \text{ T}\cdot\text{m}$
 $B = 0.22 \text{ T}$
 CONDUCTOR 8mm square
 Water cooled 5mm Hole
 Radial distance from beam ϕ to edge of coil = 10 cm

Existing Jagger PS
 $V = 220 \text{ V}$
 $I = 300 \text{ A}$

KLONG CPS

3/20/23 A. Whitt

KLONG CPS
MAGNET PROPOSAL

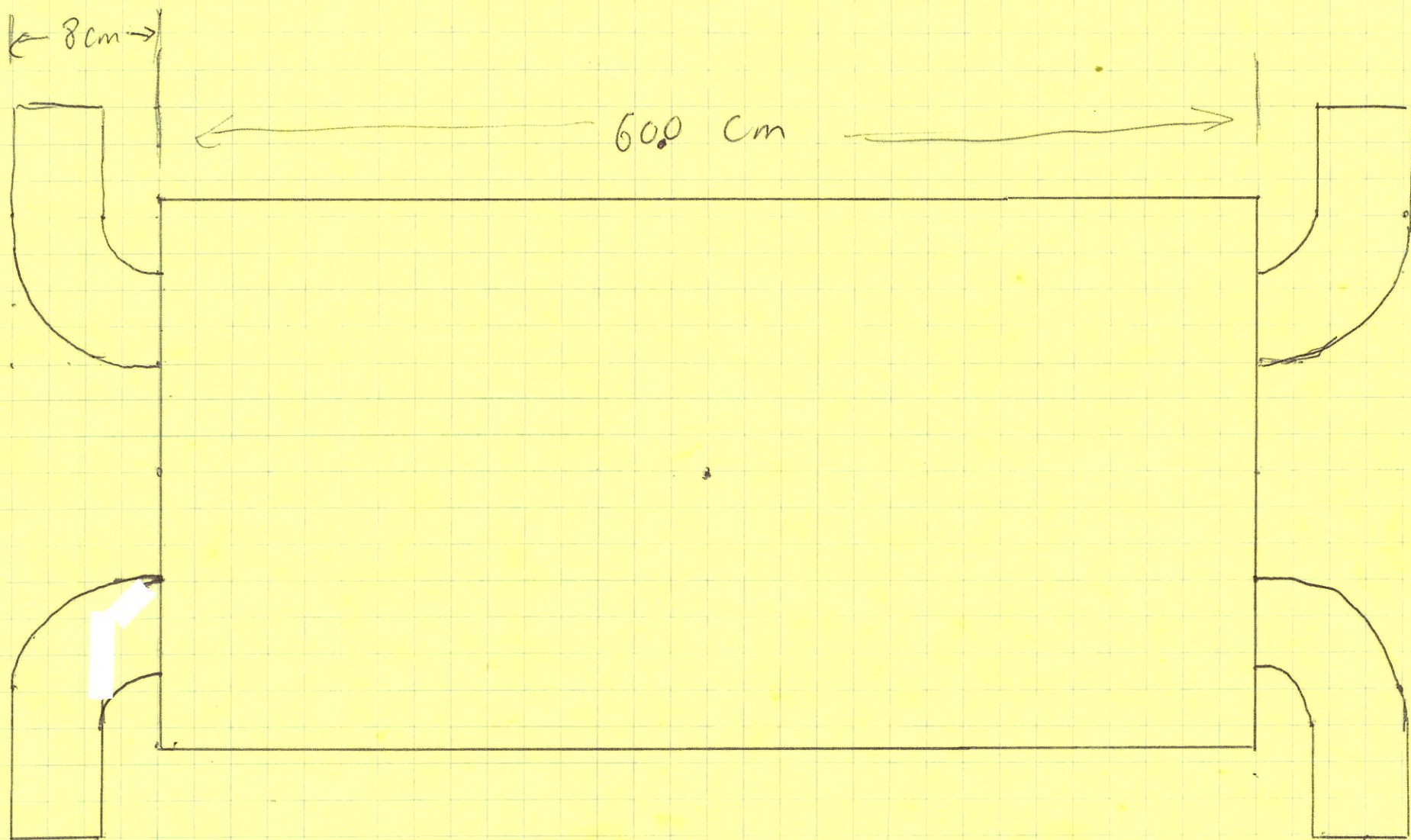

3/20/23 *[Signature]*

KLONG CPS
Magnet proposal

